

1XTP

TECHNICAL DATA

- **Materials:** Steel Zinc Plated
- **Cavity:** See Table
- **Installation torque:** See Table
- **Weight:** See Table
- **Note:** O-Ring is included

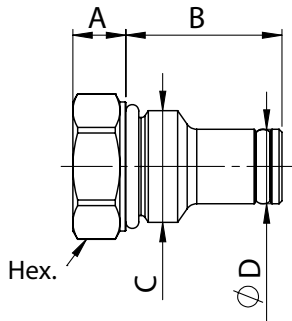

DIMENSIONS							
C	A	B	D	Hex.	Code Cavity SAE	Install. Torque (N/m)	Weight (Kg)
3/4-16-UNF	10,5	26,5	12,7	22	FW3402000	35-40	0,070
7/8-14-UNF	9,6	32,4	15,8	27	FW7802000	50-55	0,120

ORDERING CODE

1XTP



Cavities:

- 34 = SAE 08
- 78 = SAE 10

02

100